

Microscope stages

SCAN 150 x 150  
for upright microscopes

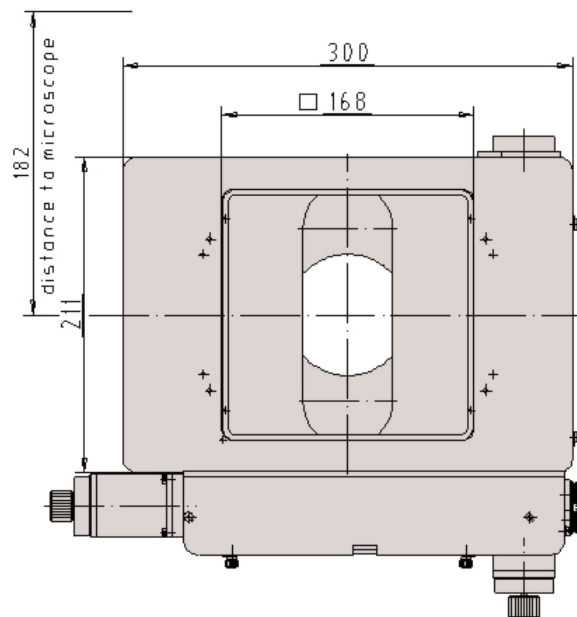
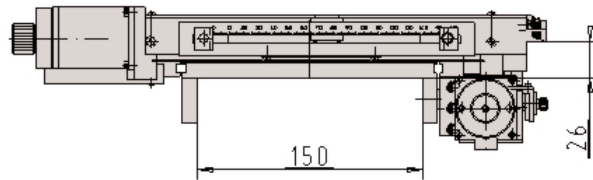

Specifications

Order information

Part No.: 00-24-601-0000  
with 1 mm lead screw pitch  
Part No.: 00-24-602-0000  
with 2 mm lead screw pitch  
Part No.: 00-24-604-0000  
with 4 mm lead screw pitch

Accessories

Stage insert for slides 3" x 1"  
Part No.: 00-29-601-8010  
Closed metal plate  
Part No.: 00-24-601-0011  
Wafer holder shown on data  
sheet "wafer holder"

Other accessories on request

2004-02-22

<b>Travel range:</b>	150 x 150 mm (6" x 6")
<b>Repeatability:</b>	< 1 µm* < 0,5 µm*, with linear encoder
<b>Accuracy:</b>	+/- 3 µm* +/- 1,5 µm*, with linear encoder
<b>Resolution:</b>	down to 1,5 nm* (0,0015 µm)
<b>Motor:</b>	2-phase stepper motor
<b>Max. travel speed:</b>	45 mm/s, 1 mm lead screw pitch 90 mm/s, 2 mm lead screw pitch 180 mm/s, 4 mm lead screw pitch
<b>Limit switches:</b>	adjustable switches
<b>Weight:</b>	4.850 g

\* Specifications valid with MÄRZHAUSER stage controller only

For more detailed information, please visit our web-site at: [www.marzhäuser.com](http://www.marzhäuser.com)

Märzhäuser GmbH & Co. KG  
In der Murch 15  
35579 Wetzlar-Steindorf  
Tel.: +49 (0) 64 41/91 16-0  
Fax: +49 (0) 64 41/91 16-40  
eMail: [info@marzhäuser.com](mailto:info@marzhäuser.com)  
[www.marzhäuser.com](http://www.marzhäuser.com)